

These drawings and specifications are the property of Seavey Engineering Associates, Inc. and shall not be used as the basis of design or manufacture without the expressly written authorization of Seavey Engineering Associates Inc. DO NOT SCALE PRINT

| ECN# | REV | DESCRIPTION | DATE | APPROVED |
|------|-----|--------------------------|----------|----------|
| 1113 | A | ORIGINAL ISSUE | 08-08-95 | AJS |
| | B | PRESSURE WAS 1/2 PSIG | | |
| | C | UPDATE TO CURRENT FORMAT | 04-04-03 | |
| | | | | |
| | | | | |
| | | | | |
| | | | | |

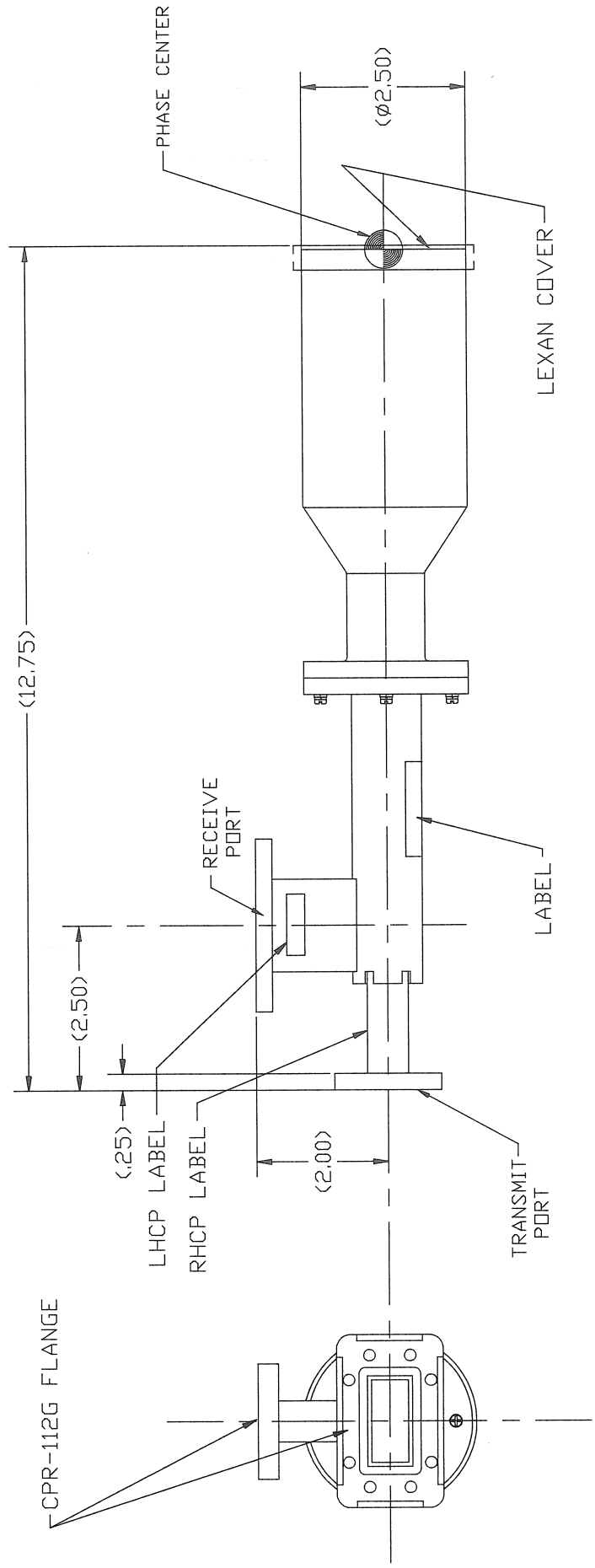

| SPECIFICATIONS: | |
|-----------------|---|
| FREQUENCY: | 7.25-7.75 GHz RECEIVE (LHCP ANTENNA) 7.9-8.4 GHz TRANSMIT (RHCP ANTENNA) |
| POLARIZATION: | DUAL CIRCULAR |
| AXIAL RATIO: | 2 dB (MAX.) |
| VSWR: | 1.4:1 (MAX.) |
| ISOLATION: | 18 dB (MIN.) Tx TO Rx |
| POWER HANDLING: | 500 WATTS C.W. |
| PRESSURE SEAL: | 1.0 PSIG (MAX.) |

FINISH
CHROMATE PER MIL-C-5541
CLASS 1A & WHITE PAINT

MATERIAL
FEED: ALUM
HARDWARE: SSTEEL
REMOVE ALL BURRS AND SHARP EDGES
DO NOT SCALE DRAWING
WORKMANSHIP SHALL BE IN ACCORDANCE WITH MIL-STD-454, REPT 9.

UNLESS OTHERWISE SPECIFIED DIMENSIONS ARE IN INCHES

| ANGLES | TOLERANCES | LINEAR |
|--------|-------------------|-------------|
| ±1° | .0135-.250 +.005 | X = ±.06 |
| | .251-.500 +.006 | XX = ±.02 |
| | .501-1.000 +.010 | XXX = ±.010 |
| | 1.001-1.000 -.001 | |

DRAWN: JBB
DATE: DA188-08-95
CHECKED: []
DATE: []
PROJ. ENG: []
DATE: []
ENG. DEPT: []
DATE: DA188-18-95
MFG. DEPT: []
DATE: []
Q.A. DEPT: []
DATE: []

SEAVEY ENGINEERING ASSOCIATES, INC.
FREDERICK, MA. 02169
DRAWING TITLE
OSA-77C

DATE PLOTTED: 04/04/03
SCALE: 1 OF 1
REV: B
9446-800
SHEET 1 OF 1